

An economical combination 30W amplifier and speaker. The new heavy-duty WSSC30 siren features Hands Free operation, Scan-Lock™ multiple warning tones and AIR HORN override capability. Designed for ease of installation into Emergency Service Vehicles that have limited space or which do not require a 100W siren system such as motorcycles or occasionally used lease vehicles. Where a higher power output is desirable, two WSSC30 sirens may be synchronised together using an optional WSSC30HK harness kit.



KEY FEATURES:

- Heavy-duty, compact rugged housing with water resistant connectors.
- Hands Free operation allows the driver to turn the siren ON, activate various siren tones and turn the siren OFF from the vehicles road horn button. Hands Free control allows the driver to control the siren system without taking his eyes off the road and hands off the steering wheel.
- Scan-Lock™ siren tones available: WAIL, YELP, PIERCER, HI/LOW, Y249, WARBLE, WOOP, TRI-TONE, ALT. WAIL and MARTIN TONE.
- Two sirens can be synchronised together using an optional WSSC30HK harness.
- Supplied with 2 way "L" mounting bracket.
- Requires 2 customer supplied switches.
- Maximum current draw 2 amps @ 15VDC.
- Weight 1.2kg

4 modes of operation selected by DIP switches at the rear of the unit:

- Instant HF 2 cycle with AIR HORN override. Default cycle tones WAIL and YELP.
- Instant HF 3 cycle with AIR HORN override. Default cycle tones WAIL, YELP and PIERCER.
- Tone 1 and tone 2 selected by individual latching switches. Tone 1 has priority over tone 2 if both switches are activated. Default tones WAIL and YELP.
- Tone 1 with AIR HORN override. Default tone 1 WAIL.

MODEL NUMBER:

WSSC30: 30 Watt Siren and Speaker Combination
WSSPA30: Same as WSSC30, Includes Public Address
WSSC30HK: Harness Kit for Synchronization of two WSSC30s



DIMENSIONS:

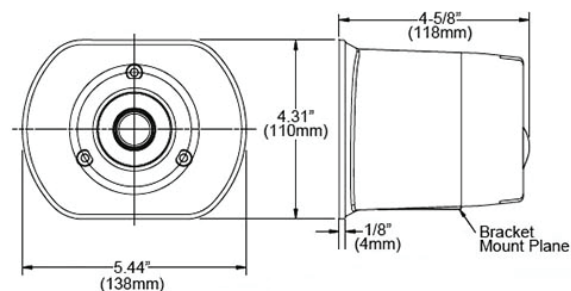

295SL

Remote mounted amplifier with Public Address and Hands Free operation, multiple warning tones and horn ring override capability. BETA Sirens allow easy set-up and configuration to meet local requirement.



KEY FEATURES:

- Economical six function siren plus radio repeat and public address.
- Power to drive up to two x 100 Watt, 11 Ω speakers.
- 17 Scan-Lock siren tones. The 295SL allows for user selectable siren tones via a momentary recessed switch, located on the rear of the unit. Choose the placement of each siren tone on rotary knob for complete user customization.
- Hands Free operation allows the driver to turn the siren ON, activate the YELP, WAIL or TWO TONE/PIECER tones and turn the siren OFF from the vehicle's road horn button. Hands Free control allows the driver to control the siren system without taking his eyes off the road and hands off the steering wheel.
- Adjustable preset microphone volume.
- Adjustable preset radio repeat volume.
- Input polarity protection.
- Output short circuit protection.
- Backward compatible to the original 295HF100

MODEL NUMBER:

295SL100: Includes Heavy-Duty Microphone, 12V
295SL101: Includes Heavy-Duty Plug-in Microphone with Volume Control Knob, 12V
295SL102: Includes Heavy-Duty Microphone, 24V



DIMENSIONS:

